

150 TAPER BORE NOZZLE **150T**

150T – Specify size when ordering

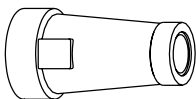

	0.70" 9317-070		0.80" 9317-080		0.90" 9317-090		1.0" 9317-100		1.1" 9317-110		1.2" 9317-120		1.3" 9317-130		1.4"	
PSI	GPM	DIA. FT.	GPM	DIA. FT.	GPM	DIA. FT.	GPM	DIA. FT.	GPM	DIA. FT.	GPM	DIA. FT.	GPM	DIA. FT.	GPM	DIA. FT.
50	100	250	130	270	165	290	205	310	255	330	300	345	350	360	408	373
60	110	265	143	285	182	305	225	325	275	345	330	365	385	380	446	396
70	120	280	155	300	197	320	245	340	295	360	355	380	415	395	483	412
80	128	290	165	310	210	335	260	355	315	375	380	395	445	410	516	427
90	135	300	175	320	223	345	275	365	335	390	405	410	475	425	547	442
100	143	310	185	330	235	355	290	375	355	400	425	420	500	440	577	458
110	150	320	195	340	247	365	305	385	370	410	445	430	525	450	605	471
120	157	330	204	350	258	375	320	395	385	420	465	440	545	460	632	481

150 TAPER RING NOZZLE **150TR**

150TR = Body + Cap + 1 Taper Ring
Specify size when ordering

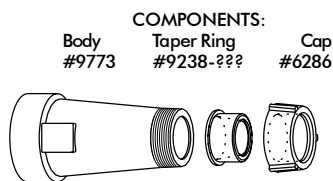
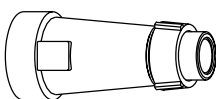

	0.88" 9238-022		0.96" 9238-024		1.04" 9238-026		1.12" 9238-028		1.2" 9238-030		1.28" 9238-032		1.36" 9238-034	
PSI	GPM	DIA. FT.	GPM	DIA. FT.	GPM	DIA. FT.	GPM	DIA. FT.	GPM	DIA. FT.	GPM	DIA. FT.	GPM	DIA. FT.
50	135	270	164	286	196	302	233	318	274	333	319	347	369	358
60	148	284	179	301	214	317	255	334	301	351	350	367	405	378
70	159	299	194	315	231	331	276	349	325	366	378	382	437	393
80	170	310	207	330	247	346	295	364	347	381	404	397	467	409
90	181	320	220	340	262	357	313	377	368	396	429	411	495	424
100	191	329	231	350	277	366	330	386	388	405	452	423	522	436
110	200	339	243	359	290	376	346	397	407	416	474	433	548	446
120	209	349	253	369	303	386	361	407	425	426	495	443	572	457

150 RING NOZZLE **150R**

150R = Body + Cap + Set of 7 Rings
Specify size when ordering

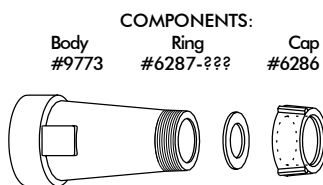
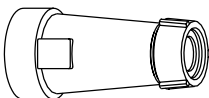

	0.86" 6287-086		0.97" 6287-097		1.08" 6287-108		1.18" 6287-118		1.26" 6287-126		1.34" 6287-134		1.41" 6287-141		1.47"	
PSI	GPM	DIA. FT.	GPM	DIA. FT.	GPM	DIA. FT.	GPM	DIA. FT.	GPM	DIA. FT.	GPM	DIA. FT.	GPM	DIA. FT.	GPM	DIA. FT.
50	100	245	130	265	165	285	205	300	255	320	300	335	350	350	385	353
60	110	260	143	280	182	300	225	315	275	335	330	350	385	365	423	368
70	120	270	155	290	197	310	245	330	295	350	355	365	415	380	458	383
80	128	280	165	300	210	320	260	340	315	360	380	380	445	395	490	399
90	135	290	175	310	223	330	275	350	335	370	405	390	475	405	522	409
100	143	300	185	320	235	340	290	360	355	380	425	400	500	415	550	419
110	150	310	195	330	247	350	305	370	370	390	445	410	525	425	577	429
120	157	315	204	335	258	360	320	380	385	400	465	420	545	435	603	439

Diameters are based on 24° trajectory. Big Gun® performance data has been obtained under ideal test conditions and may be adversely affected by wind, poor hydraulic entrance conditions or other factors. Nelson Irrigation Corporation makes no representation regarding droplet condition, uniformity, or application rates.